

公差表/General tolerances(mm)		0	>3	>6	>10	>18	>30	>50	>80	>120	>180	>250	>315	>400	>500	0.1/1/10
~	~	~	~	~	~	~	~	~	~	~	~	~	~	~	~	±Z
±0.12	±0.18	±0.22	±0.26	±0.31	±0.37	±0.57	±0.80	±0.93	±1.05	±1.15	±1.60	±2.20	±2.50	±2.50	±Z	±Z

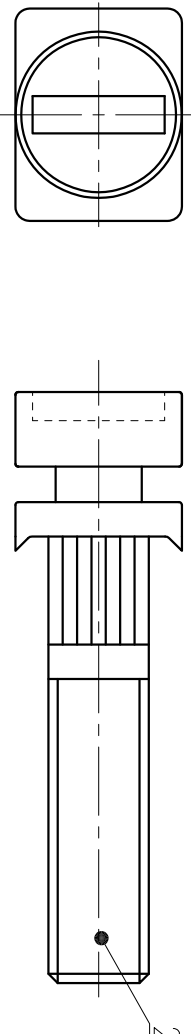
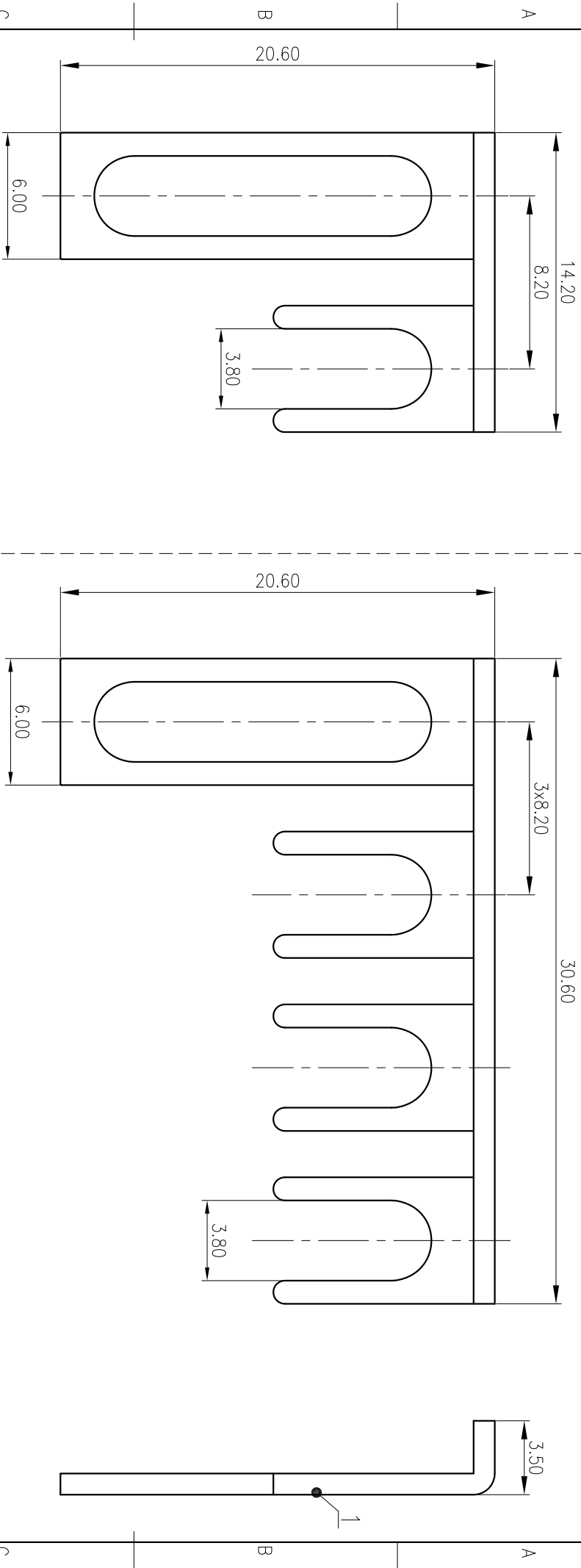

ITEM	NAME OF PART	MATERIAL	NOTES
2	Screw	Copper alloy M3.5/Ni Plated	
1	Bridge	Copper	Sn Plated

螺丝扭矩/Torque Tightening(N·m/Lb.in) M3.5, 0.8/7.02
 间距/Pitch(mm)/线数范围/Poles 8.20/02,04P
 符合RoHS环保要求/Conform to RoHS
 SURFACE: /

宁波高松电子有限公司
 NINGBO DEGSON ELECTRICAL CO., LTD

SBXX-RTK/S

REV	ECN	DESCRIPTION	DRFT	DATE	SIZE: A4	SCALE: 4:1	REV
					(mm)		DD-4
					(inch)		1/1
APPD: Li GL 2020.06.06		NAME: SB-RTK/S-C01		CHKD: Mao J 2020.06.06	DRAWING NO.: SB-RTK/S-C01		REV
DRFT: Huanggs 2019.07.24		TYPE: CUSTOMER DRAWING		SCALE: 4:1		SHEET	1/1

