

CONDUCTIVE POLYMER ALUMINUM ELECTROLYTIC CAPACITORS

FV Lead type, With Conductive Polymer Series

- Load life for 5000 hours at 105°C
- Mother board and VGA card for computer

Hi-CAP

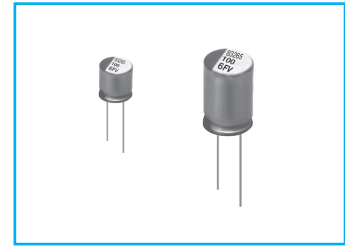

FB → FV
Long life

Item	Characteristics	
Operating temperature range	-55 ~ +105°C	
Leakage current max.*	Less than or equal to the value of Table1	
Capacitance tolerance	±20% at 120Hz, 20°C	
Dissipation factor max.	Less than or equal to the value of Table1	
ESR	Less than or equal to the value of Table1	
Temperature characteristics (Impedance ratio at 100kHz)	Z-55°C / Z+20°C	Z+105°C / Z+20°C
	0.75 ~ 1.25	0.75 ~ 1.25
Load life (after application of the rated voltage for 5000 hours at 105°C)	Leakage current	Less than specified value
	Capacitance change	Within ±20% of initial value
	ESR	Less than 150% of specified value
	tanδ	Less than 150% of specified value

* In case of some problems for measured values, measure after applying rated voltage for 120 minutes at 105°C.

DRAWING

Unit : mm

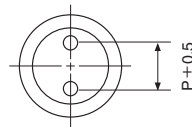
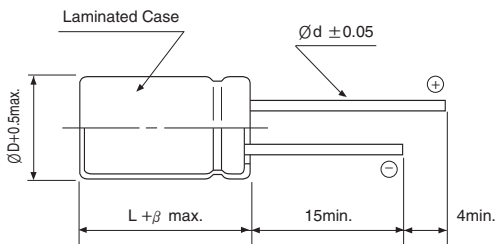

PART NUMBER SYSTEM (See Page 52)

Size	ØD	L	P	Ød	β
6.3×8	6.3	8.0	2.5	0.45	1.5
8×9	8.0	9.0	3.5	0.60	1.5
8×12	8.0	12.0	3.5	0.60	1.5

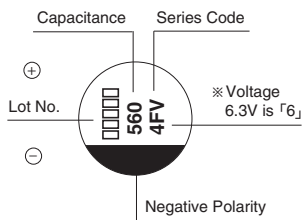

Table 1. FV(Lead type) Series Characteristics List

WV	μF	ØD(mm)	L(mm)	ESR(mΩ)max. 100~300kHz	Ripple current (mA rms) at 105°C 100kHz	Dissipation factor 120Hz	Leakage Current (μA) (max.) after 2 minutes
2.5	820	6.3	8	7	5000	0.10	500
		8	9	7	6100	0.10	410
4	560	6.3	8	7	5000	0.10	500
		6.3	8	8	4700	0.10	592
		6.3	8	8	4700	0.10	706
6.3	560	6.3	8	8	4700	0.10	706
		8	9	8	6100	0.10	706
16	100	6.3	8	25	2820	0.10	320
		8	12	11	5000	0.10	864

FREQUENCY COEFFICIENT OF PERMISSIBLE RIPPLE CURRENT

Frequency	120Hz	1kHz	10kHz	100~500kHz
Coefficient	0.05	0.3	0.7	1