

JCB014 GPS GSM Combo Antenna

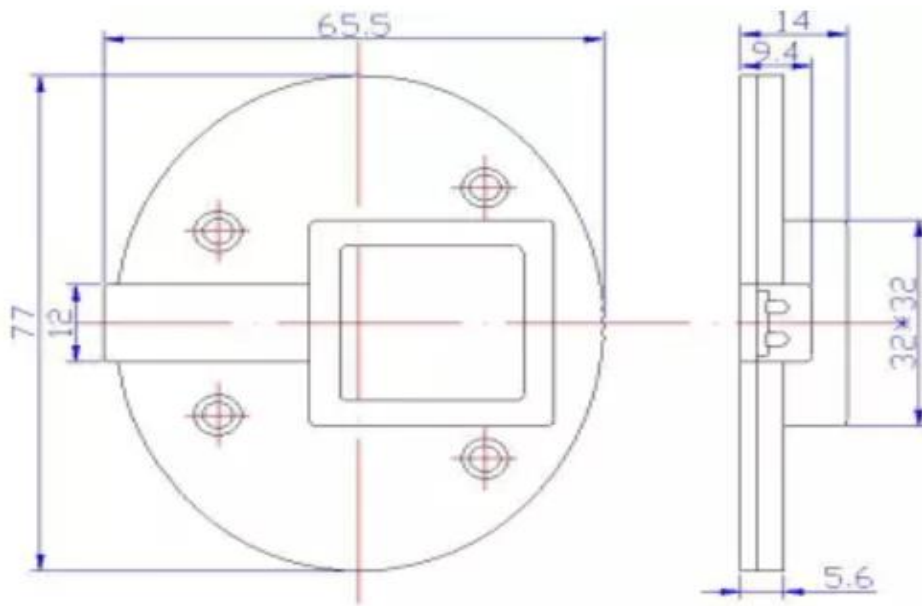

No.	Item	Specifications	Post Environmental Tolerance
1	Center Frequency	1575.42 MHz	±3 MHz
2	Band Width	±5 MHz	±1 MHz
3	V.S.W.R (in BW)	1.5 : 1	—
4	Gain (Zenith)	3 dB	±0.5 dB
5	Polarization	RHCP	—
6	Impedance	50 Ω	—

3.2 LNA/Filter

Form 2

No.	Item	Specifications	Post Environmental Tolerance
1	LNA Gain	28±2 dB	±2.5 dB
2	Noise Figure	1.5 dB	—
3	Filter Out Band Attenuation	12dB Min f0+50MHz 16dB Min f0-50MHz	± 1.0 dB
4	DC Voltage	2.2~5 V	
5	DC Current	5~15 mA	

3.3 GSM Antenna

Form 3

No.	Item	Specifications	
1	Frequency	824~960 MHz/1710~1990 MHz	
		1920~2170 MHz	
2	V.S.W.R (5m)	≤2.0 : 1	
3	Gain (Zenith)	2 dBi	
4	Impedance	50 Ω	

3.4 Mechanical

Form 4

No.	Item	Specification	
1	Cable	RG174 3m/5m or others	
2	Connector	SMA/SMB/MCX or others	
3	Plastic Housing	Black	
4	Mounting	Screw/Adhesive	