

SiC Mosfet Modules 

Type	V <sub>DSS</sub> V	I <sub>b</sub> A	R <sub>DS(on)</sub> @T <sub>j</sub> =25°C max. mOhm	R <sub>th(J-C)</sub> K/W	Package Outline/page	Circuit
------	-----------------------	---------------------	---	-----------------------------	-------------------------	---------

**SiC Mosfet**

MD120HFR120C2S	1200	120	13	0.181	C2.0/43
MD300HFR120C2S	1200	300	6.5	0.100	C2.0/43
MD400HFR120C2S	1200	400	4.4	0.074	C2.0/43
MD200HFR170C2S	1700	200	8.7	0.058	C2.0/43
MD250HFR170C2S	1700	250	10.4	0.069	C2.0/43
MD120HFR120B3S	1200	120	13	0.181	B3.7/43
MD300HFR120B3S	1200	300	6.5	0.100	B3.7/43
MD400HFR120B3S	1200	400	4.4	0.074	B3.7/43
MD200HFR170B3S	1700	200	8.7	0.058	B3.7/43
MD250HFR170B3S	1700	250	10.4	0.069	B3.7/43

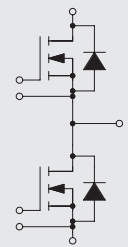



Case C2.0

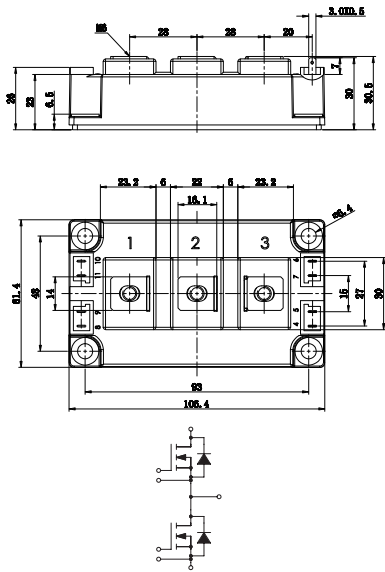

Case B3.7

